

2022

URBAN TILTH
ANNUAL REPORT

**NO
SHADE**

2022

**AN EPIC
BATTLE WON**

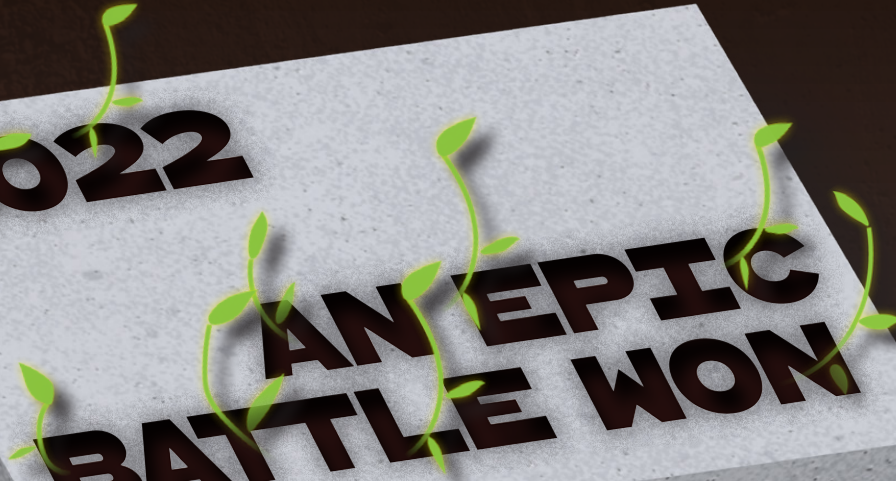

Dirty Development Versus a Community Vision of Health and Sustainability.

In 2022, within 1 month of purchasing the North Richmond Farm, Urban Tilth found out that our dream of growing a healthy, community driven vision for positive development in North Richmond was being threatened by a new massive Panattoni Inc. project planned for the parcels on the eastern boundary of our farm and that this planned development would severely impact the youth in the nearby elementary school as well as our farm.

The structures proposed would dramatically increase local emissions, reduce the sunlight to the farm up to 4 hours a day impacting our capacity to grow the healthy foods that feed hundreds of local families each week.

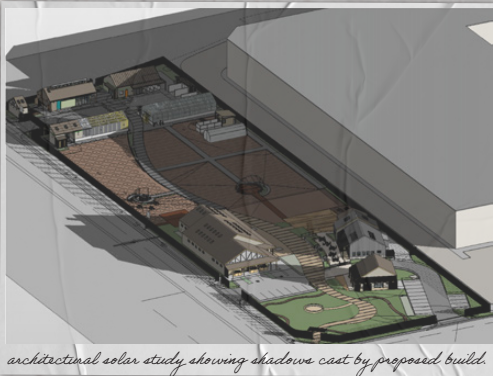

The development would also threaten community health by locating yet another large scale warehouse/ fulfillment center that will bring in over 150 additional trucks and other vehicles to the site each day, increasing air pollution and street traffic to a community that already disproportionately suffers from asthma and other emissions-related chronic illnesses.

This Panattoni Inc development at the site of the historic Nabeta Family Farm is one of many developments engulfing Richmond and North Richmond in hundreds of thousands of sq ft of warehouse and fulfillment center spaces and thousands of new truck and other vehicle traffic.

In 2022 we designed and launched the **#NoShade** campaign to disrupt business as usual that disregards community health and uplifts development despite the negative community impacts and developed a collective vision that will honor all our relatives who came before us, employ more local residents and put community health first.

We held a community protest on the streets surrounding the farm to try to get

the attention of both the property owners and Panattoni Inc, both of whom would not communicate with us in the early months of 2022. After the LA Times wrote a powerful story about our fight, *A widow, a warehouse, an urban farm: Questions of justice flare in the Bay Area*, on May 5, 2022, the Nabeta family reached out and offered Urban Tilth an opportunity to make a counter offer in case Panattoni was willing to release their option on the land. This new opportunity was overwhelming but it also meant we would need to raise a considerable amount of money (millions of dollars) within 1 month. We scrambled to find support, reaching out to multiple partners to help us reach those with the capacity to make this vision a reality. After many minor miracles and one major donation from an anonymous Angel donor we were able to successfully secure the funds by May 31, 2022. When Panattoni released their option on the land in June 2022 Urban Tilth submitted a counter offer which was happily accepted by the Nabeta family with some negotiations to make sure the family had what they needed going forward.



THIS WIN WAS SO EPIC!

We could have never foreseen that we would need to wage such a battle and had no inkling we could and would win! All we knew was that this would radically change the potential impact of our work for decades to come.

As we worked through the acquisition process through the rest of 2022 we also began to look forward and dream into the future of the Nabeta Farm

OUR CURRENT VISION

Our current vision is to preserve the history and agricultural functions of the Nabeta Farm by transforming it into a permanent, community-owned farm that would serve as a community hub offering space for expanding agricultural social entrepreneurial projects, expanding our food hub, resiliency center and creating new art and other

community gathering spaces. This project would serve as a source of inspiration and resources that would feed our communities' hearts and minds, bellies, and spirits for generations to come.

SOME ELEMENTS OF OUR INITIAL VISION INCLUDE:

- Historical preservation and storytelling
- Land preservation
- Expand farming & food hub operations
- Incubation of agricultural and cooperative enterprises
- Community resiliency center
- Affordable housing
- Community art studio space
- Community gathering place

As you can see, there is a cornucopia of ideas and excitement from community members for the stewardship and development of the Nabeta Farm. We know not all of these ideas are possible due to space and other constraints. Once the acquisition is finalized, we will complete an extensive assessment and discovery process, in order to flesh out these ideas. From there, we will raise the funds needed to complete a comprehensive community design process and develop a schematic design for the future of the Nabeta Farm.

THERE IS SO MUCH MORE TO COME!

A 3D rendering of a concrete block with the text "OUR IMPACT" and green sprouts growing from it. The block is light gray with a textured surface. The text is in a bold, dark brown font. Several green sprouts with two leaves each are growing from the letters. The background is dark brown.

**OUR
IMPACT**

162,000 LBS food distributed
to the community...

21,961 LBS of which was
Urban Tithing grown.



27,631 LBS food distributed by free farm stands to community members at Richmond Greenway, North Richmond, Crescent Park, and Richmond High School.



8,644 community volunteers and participants.

65 workshops and
garden education classes.

53 cooking classes

235 special events and
community cleanups.



1,555 WCCUSD students engaged.

35 Richmond and San Pablo Youth trained at Summer Youth Apprenticeship Program.





683 cubic yards of illegal dumping removed from community spaces—that's enough trash to cover an entire football field in three inches of trash.

572 fruit trees given to local community members.

772 native & pollinator plants planted.

1,244 eggs laid!

A 3D rendering of a grey concrete block with a rough, pebbled texture. The block is positioned at an angle, showing its top and two side faces. On the top surface, the text "2022 FINANCIALS" is printed in a bold, dark brown, sans-serif font. The text is slightly raised from the surface. Several small, vibrant green sprouts with thin stems and two leaves each are growing from the top surface, interspersed among the letters of the text. The background is a dark, gradient grey, and the lighting creates soft shadows on the block's edges.

**2022
FINANCIALS**

TOTAL INCOME \$12,038,408

TOTAL EXPENSES \$3,027,117

Salaries & Benefits \$3,199,006 74%

Program Expenses \$1,084,203 25%

Operating Expenses \$49,943 1%



**OUR
DONORS**

A 3D rendering of a concrete block with the text "OUR DONORS" on top. The text is in a bold, dark red font. Small green plants with two leaves are growing from the letters. The block is set against a dark background.

11TH HOUR
BENEVITY
BLACKBERRY CREEK FOUNDATION
BRIDGEBUILDERS FOUNDATION
BRIGHT FUNDS FOUNDATION
CALIFORNIA ENDOWMENT
CERES TRUST
CHAMBERLIN FAMILY FOUNDATION
CHORUS FOUNDATION
CITY OF ALBANY
CITY OF RICHMOND
CLIMATE JUSTICE ALLIANCE
COMMUNITY ALLIANCE OF
FAMILY FARMERS (CAFF)
EAST BAY COMMUNITY FOUNDATION
ELIZABETH R. & WILLIAM J. PATTERSON
FOUNDATION
FIDELITY CHARITABLE
FOUNDATION FOR SUSTAINABILITY
AND INNOVATION
GAMBLE FOUNDATION
GLASS HALF FULL
HELLMAN FAMILY FOUNDATION
IMPACT ASSETS
JASON KATZ-BROWN FIDELITY CHARITABLE FUND

JUSTICE JUSTICE FOUNDATION
KAISER FOUNDATION
KATALY FOUNDATION
KOSHLAND WACHTEL FUND
MAGIC CABINET FOUNDATION
MANZANITA FOUNDATION
MARIN COMMUNITY FOUNDATION
MECHANICS BANK
MIGHTY ARROW
NEEDLEGRASS FUND
PATAGONIA FOUNDATION
RACHEL'S NETWORK
RSF SOCIAL FINANCE
SAN FRANCISCO FOUNDATION
SCHWAB CHARITABLE
SILICON VALLEY COMMUNITY FOUNDATION
STUPSKI FOUNDATION
SUNLIGHT GIVING
THE HENRY E. & MARY R ANDERSON FAMILY
FOUNDATION
USDA
VANGUARD CHARITABLE
VIOLET WORLD FOUNDATION
WILMINGTON



THANK YOU!

URBAN TILTH is deeply grateful to all of our funders who believe in the work we do and make it possible for us to continue to serve our community. It is of the utmost importance to give thanks, especially to those funders who contributed to the North Richmond Farm Capital Campaign Fund. Because of this significant investment and unwavering partnership we are set up to start the first two phases of construction! We also want to say a special thank you to all those funders who went above and beyond and showed up for us in ways philanthropy rarely does.

